

# 노측용 차량방호울타리 지주 보강 항타식 지중 앵커 방식(Φ60.5)-L1200

앵커 조립

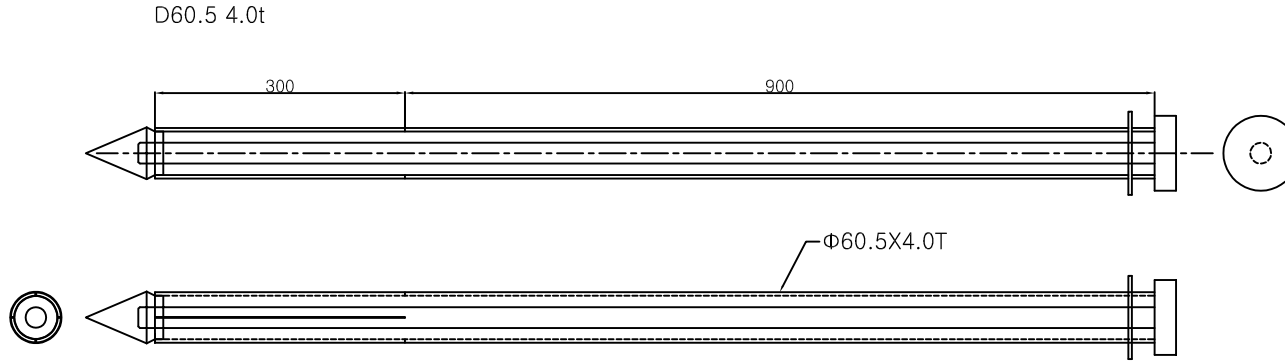

뺨기 상세

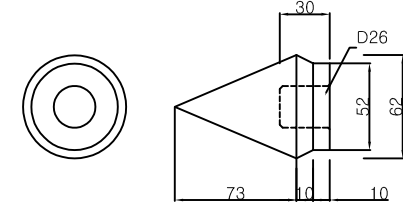

앵커 상세

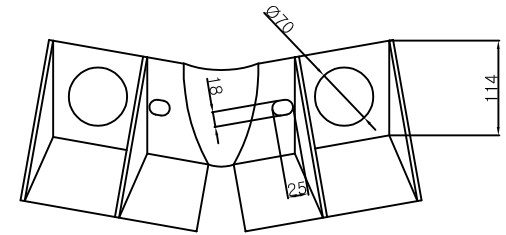
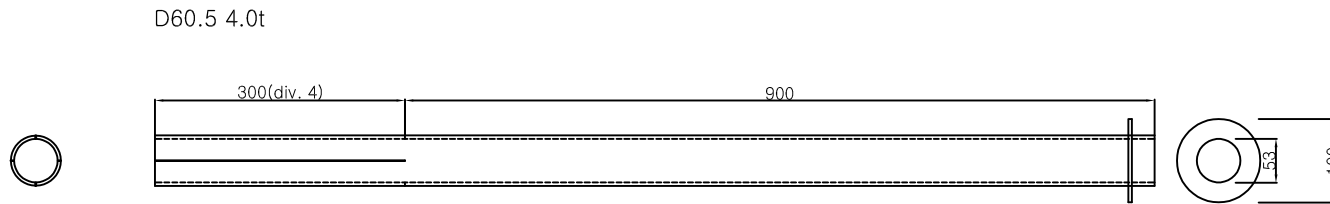

브라켓상세도

항타봉

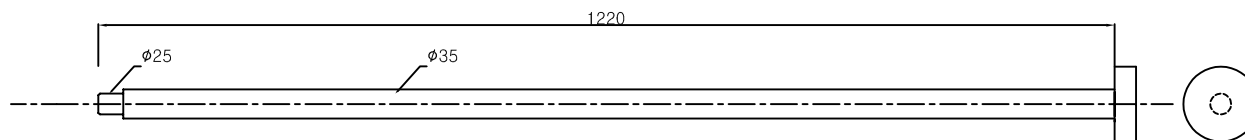

재 료 표

( 개 소 당 )

NO.	품 명	규 격	수량	단위	재 질	비고
4	U-BOLT	M16	1	EA		용융아연도금
3	뺨기	Φ62	2	EA		용융아연도금
2	브라켓	460 x 114 x 6T	1	EA	SS400	용융아연도금
1	ANCHOR	Φ60.5X4.0TX900-1,200	2	EA	SS400	용융아연도금

\*항타봉은 재사용